

# Rocksteady



## Quick connect lift tool

The Rocksteady lift tool is a quick connector for heavy offshore lifting operations. A fail-safe and visually verifiable lock guarantees safe lifting while saving hours of sling handling.

### Save time

Use a single tool for all lifting operations to avoid repetitive and time consuming rigging operations. Rocksteady uses standard lifting interfaces so you maintain complete control and flexibility.

### Easy to operate

Long range handheld remote control, crane cabin integration or direct hydraulic operation; the Rocksteady lift tool will be a seamless addition to your lifting operations.

### Tough and reliable

Rocksteady is a field proven design ready for rough handling, wear and tear. The lock function can be easily inspected and maintained offshore; and you have manual override in the event of hydraulic supply issues.

### Safe as a shackle

Quality manufacture from forged products with load transferred under machined shoulders. Rocksteady is designed and delivered to offshore lifting regulations, with individual load test and 100% NDT. Rocksteady is impossible to partially lock and features clear visual indication of lock/unlock status to provide a quick reference to all personnel that a lift is safe to proceed.

SRP

ACTEON

# Specifications

<b>Design &amp; manufacture</b>	DNVGL-ST-0378 - Standard for offshore and platform lifting appliances May 2016 Proof load, volumetric and surface NDT, 3.1 certs, CE marking
<b>Applications</b>	Offshore wind pile lifting tools, transition piece lifting tools Hammers, drilling and piling equipment Crane shock absorbing devices Oil & gas decommissioning lifts Marine riser installation and retrieval
<b>Control options</b>	Direct hydraulic, radio remote control (range up to 300m), acoustic remote control (subsea)
<b>Tested performance</b>	High speed impact (3m/s), offset and 15° angled connection Connect / disconnect endurance (no galling, no wear)
<b>Receptacle options</b>	Padeye (shackle interface), trunnions for slings, bolted flange, self-righting receptacle with free-stroke (hammer/crane isolation), receptacle mounted actuation (connector passive)

Model	RSL500	RSL1000	RSL2000	RSL3000
<b>SWL (metric)</b>	500t	1000t	2000t	3000t
<b>Weight (t)</b>	1.2	3.4	9.4	17.3
<b>Diameter (mm)</b>	450	640	900	1100
<b>Length (mm)</b>	1135	1600	2265	2775

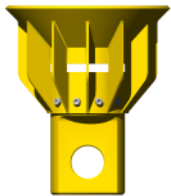

Standard receptacle with shackle interface. Available with stands to sit flat on deck.

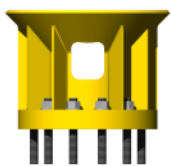

Bolted flange receptacle. Available with extended funnel (as shown) for up-righting of moderate loads.

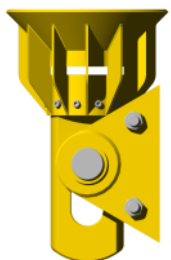

Always-up, telescoping receptacle. Ideal for up-righting heavy loads and isolating crane from pile hammering.



One of four custom Rocksteady hydraulic lift tools delivered for an O&G client.

# Rocksteady

# ACTEON

[www.srpsubsea.com](http://www.srpsubsea.com) | [info@srpsubsea.com](mailto:info@srpsubsea.com) | +44 (0) 1483 775 000

Every effort has been made to ensure the data on this sheet is accurate at the time of issue, however, it is subject to revision. SRP is a division of Large Diameter Drilling Ltd, an Acteon Company. Rocksteady is a trademark of Large Diameter Drilling Ltd ©